

## EXPLANATION OF SPECIFICATIONS

<b>Part Number:</b>	The catalog number for the individual shock absorber.
<b>Extended Length*:</b>	The length of the shock absorber when it is fully extended. See "How to Measure" instructions.
<b>Collapsed Length*:</b>	The length of the shock absorber when it is fully collapsed. See "How to Measure" instructions.
<b>Stroke:</b>	This is the approximate length of the stroke of the individual shock absorber being described.
<b>Mounting Codes:</b>	Indicates the type of mounting ends for the upper and lower end of each shock absorber. They are listed as follows: Top mounts ("TM") Eye ring and bushing with sleeve mounts ("ES") Stud type mounts ("S" & "DS") Eye ring and bushing with bar pin mounts ("BP") Special mounting codes ("SP") Eye ring and bushing mounts ("EB") Clevis mounts ("CL") Pinch socket mounts ("LP") U joint mounts ("LU")

### CONVERSION CHART

Fraction	Decimal	Metric	Fraction	Decimal	Metric
(Inches)	(Inches)	(MM)	(Inches)	(Inches)	(MM)
1/64	0.016	0.397	33/64	0.516	13.097
1/32	0.031	0.794	17/32	0.531	13.494
3/64	0.047	1.191	35/64	0.547	13.891
1/16	0.063	1.588	9/16	0.563	14.288
5/64	0.078	1.984	37/64	0.578	14.684
3/32	0.094	2.381	19/32	0.594	15.081
7/64	0.109	2.778	39/64	0.609	15.478
1/8	0.125	3.175	5/8	0.625	15.875
9/64	0.141	3.572	41/64	0.641	16.272
5/32	0.156	3.969	21/32	0.656	16.669
11/64	0.172	4.366	43/64	0.672	17.066
3/16	0.188	4.763	11/16	0.688	17.463
13/64	0.203	5.159	45/64	0.703	17.859
7/32	0.219	5.556	23/32	0.719	18.256
15/64	0.234	5.953	47/64	0.734	18.653
1/4	0.250	6.350	3/4	0.750	19.050
17/64	0.266	6.747	49/64	0.766	19.447
9/32	0.281	7.144	25/32	0.781	19.844
19/64	0.297	7.541	51/64	0.797	20.241
5/16	0.313	7.938	13/16	0.813	20.638
21/64	0.328	8.334	53/64	0.828	21.034
11/32	0.344	8.731	27/32	0.844	21.431
23/64	0.359	9.128	55/64	0.859	21.828
3/8	0.375	9.525	7/8	0.875	22.225
25/64	0.391	9.922	57/64	0.891	22.622
13/32	0.406	10.319	29/32	0.906	23.019
27/64	0.422	10.716	59/64	0.922	23.416
7/16	0.438	11.113	15/16	0.938	23.813
29/64	0.453	11.509	61/64	0.953	24.209
15/32	0.469	11.906	31/32	0.969	24.606
31/64	0.484	12.303	63/64	0.984	25.003
1/2	0.500	12.700	1	1.000	25.400

### METRIC CONVERSION CHART

MILLIMETERS	INCHES	MILLIMETERS	INCHES	MILLIMETERS	INCHES
1	0.03937	10	0.39370	19	0.74803
2	0.07874	11	0.43307	20	0.78740
3	0.11811	12	0.47244	21	0.82677
4	0.15748	13	0.51181	22	0.86614
5	0.19685	14	0.55118	23	0.90551
6	0.23622	15	0.59055	24	0.94488
7	0.27559	16	0.62992	25	0.98425
8	0.31496	17	0.66929		
9	0.35433	18	0.70866		

# HOW TO MEASURE EXTENDED & COLLAPSED LENGTHS OF SHOCK ABSORBERS

## Instructions

- Using the proper measuring points as shown above find the nearest replacement shock absorber from the listing increments of extended length.
- Identify the proper mounting form the mounting codes and match these requirements by carefully measuring the mounting dimensions (top and bottom) of the shock absorber to be replaced.
- Carefully take note of the following requirements:
  - Mounting Accessories** - Contents and descriptions of parts are shown in this manual.
  - Dust tubes** - This requirement should be noted in comparison with the shock absorber to be replaced. Shock absorber environment in its application makes this requirement necessary for piston rod protection and extended shock absorber life.
  - Recoil Cutoff and Compression Bumper** - Carefully note these specifications- deviation of length requirements should not exceed  $\pm 1/2"$ . These shock absorber designs are footnoted for easy identification.
  - Limited Environment Application** - Most conventional shock absorbers are offered in "straight" construction to fit limited environment applications. These shock absorber designs are footnoted.

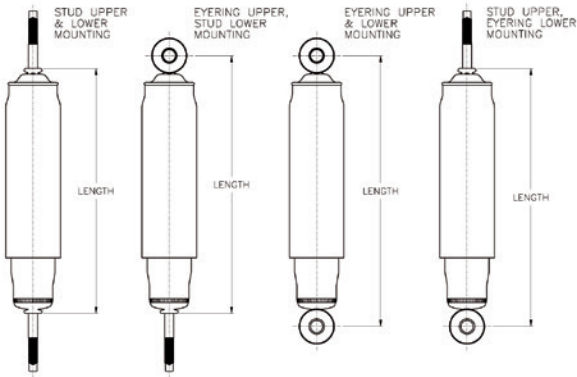

## SHOCK ABSORBER DIAMETERS

Shown below are measuring points for diameters by type of shock absorber. Refer to the chart below which lists diameters for the various bore sizes available for each type.

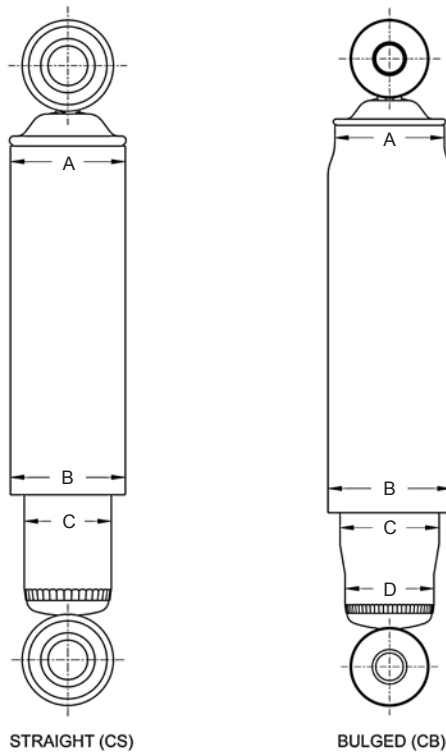

BORE SIZE	SHOCK ABSORBERS	TYPE (Shown Above)	Diameters			
			A	B	C	D
1 3/16"	Classic, Guardian, Ultra Pass. Car	CS	2.06	2.00	1.63	NA
1 3/16"	Classic, Guardian, Ultra Pass. Car	CB	2.06	2.19	1.81	1.63
1 3/8"	Ultra Truck	CS	NA	2.37	2.00	NA
1 3/8"	Ultra Truck	CB	2.37	2.50	2.19	2.00

# EXTERNAL DIMENSIONS

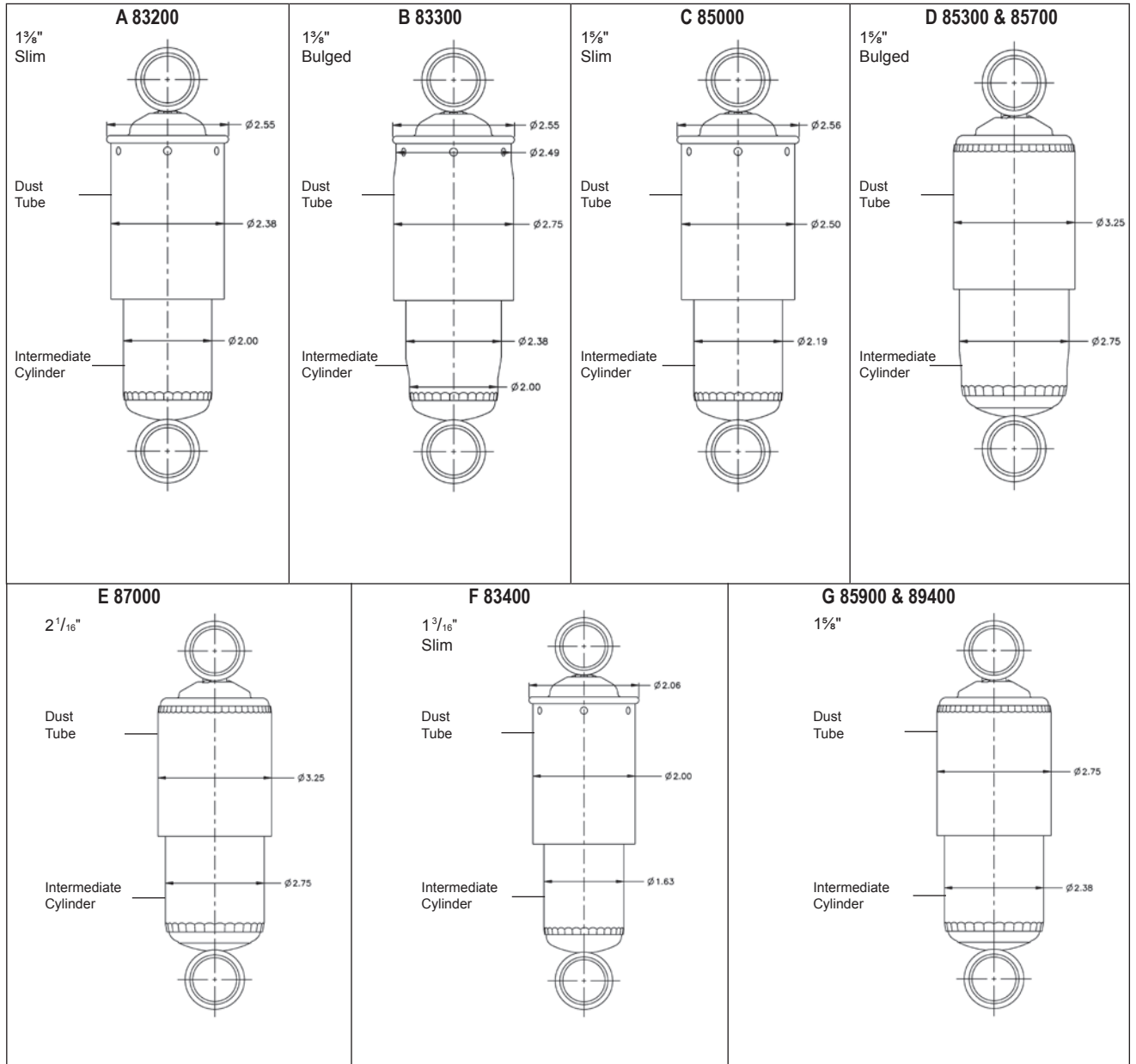

## MOUNTING CODE "EB" EYE RING AND BUSHING

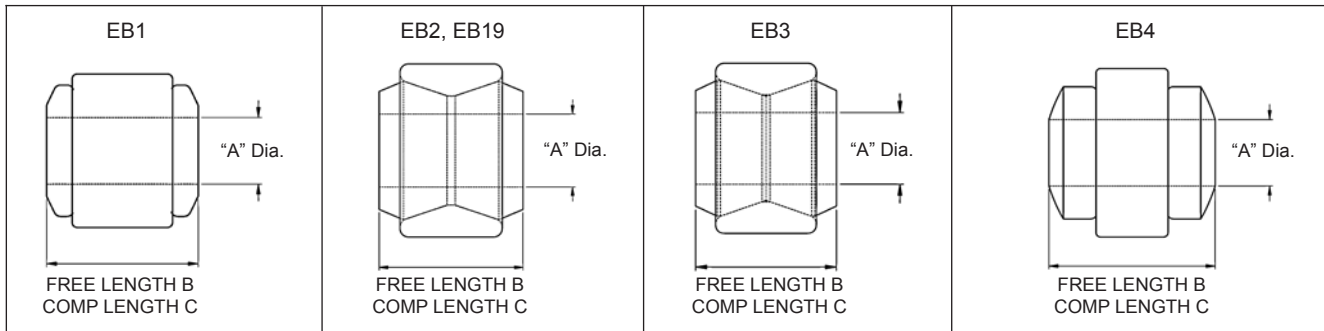

MOUNTING CODE	A DIAMETER	B FREE LENGTH	C COMP. LENGTH	VEHICLE MOUNTING PIN DIAMETER
EB1	5/8	1.44	1.31	5/8
EB2	3/4	1.75	1.50	3/4
EB3	1.00	1.91	1.75	1.00
EB4	11/16	1.72	1.55	11/16
EB18	19MM	1.65	-	19MM
EB19	20MM	1.75	1.25	20MM

## "DS" & "S" STUD MOUNTS

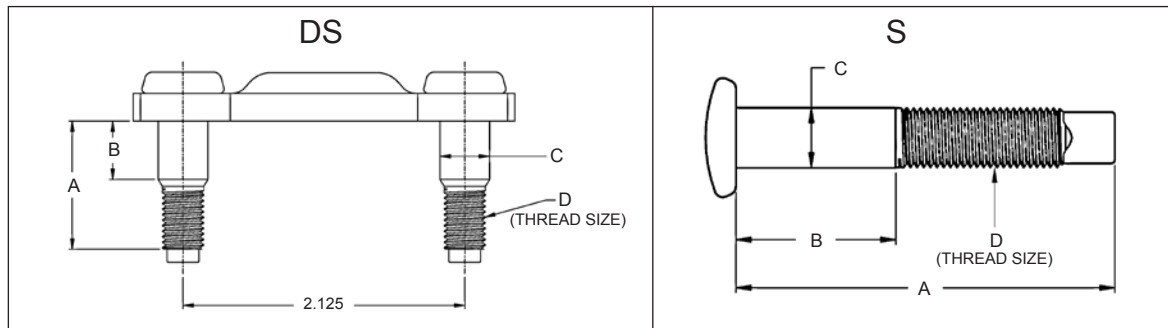

MOUNTING CODE	DIMENSION						
	A		B		C		D
	(inches)	(mm)	(inches)	(mm)	(inches)	(mm)	(thread)
<b>DS1</b>	1.27		.66		0.38		5/16-24
<b>S1</b>	2.37	60.20	1.00	25.40	0.38	9.53	3/8-24
<b>S11</b>	3.00	76.20	1.12	28.45	0.38	9.53	3/8-24
<b>S12</b>	2.37	60.20	1.15	29.21	0.44	11.11	3/8-24
<b>S16</b>	2.95	74.93	1.45	36.83	0.63	16.00	M16x1.5
<b>S21</b>	3.28	83.31	1.75	44.45	0.63	15.88	5/8-18
<b>S29</b>	2.99	75.95	1.87	47.50	0.38	9.53	3/8-24
<b>S36</b>	2.49	63.25	1.33	33.78	0.44	11.11	3/8-24
<b>S38</b>	2.75	69.85	1.70	43.18	0.55	14.00	M12x1.25
<b>S40</b>	2.52	64.01	1.33	33.78	0.44	11.11	3/8-24
<b>S42</b>	3.50	88.90	2.00	50.80	0.63	15.88	5/8-18
<b>S43</b>	2.75	69.85	1.25	31.75	0.63	15.88	5/8-18
<b>S47</b>	2.20	55.88	1.31	33.27	0.39	10.00	M10x1.25
<b>S61</b>	3.11	78.99	1.45	36.83	0.55	14.00	M12x1.25
<b>S62</b>	3.24	82.30	1.70	43.18	0.56	14.29	M12x1.25
<b>S68</b>	2.95	74.93	1.45	36.83	0.63	15.88	M16x1.5
<b>S92</b>	1.42	36.07	0.63	16.00	0.41	10.41	M12x1.25

## MOUNTING CODE "BP" EYE RING AND BUSHING WITH BAR PIN

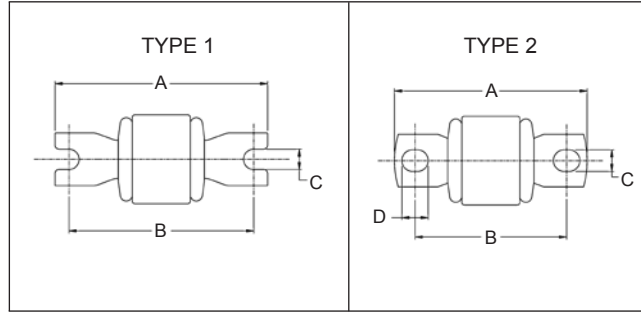

MOUNTING CODE	TYPE	DIMENSION									
		A		B		C		D		E	
		(inches)	(mm)	(inches)	(mm)	(inches)	(mm)	(inches)	(mm)	(inches)	(mm)
<b>BP4</b>	<b>1</b>	3.19	81.03	2.38	60.45	0.33	8.38	--	--	--	--
<b>BP6</b>	<b>1</b>	4.25	107.95	3.62	91.95	0.33	8.38	--	--	--	--
<b>BP7</b>	<b>2</b>	3.13	79.50	2.50	63.50	0.35	8.89	0.42	10.67	--	--
<b>BP8</b>	<b>2</b>	3.50	88.90	2.87	72.90	0.35	8.89	0.42	10.67	--	--
<b>BP9</b>	<b>1</b>	3.38	85.85	2.6	66.04	0.35	8.89	0.42	10.67	--	--
<b>BP11</b>	<b>1</b>	2.96	75.18	2.52	64.01	0.33	8.38	--	--	--	--
<b>BP13</b>	<b>1</b>	3.45	87.63	3.00	76.20	0.33	8.38	--	--	--	--
<b>BP14</b>	<b>2</b>	3.43	87.12	2.87	72.90	0.45	11.43	--	--	--	--
<b>BP27</b>	<b>2</b>	4.00	101.60	2.95	74.93	0.52	13.21	0.50	12.70	--	--
<b>BP38</b>	<b>2</b>	3.22	81.79	1.54	39.12	0.40	10.16	0.40	10.16	--	--

## MOUNTING CODE "ES" EYE RING AND BUSHING WITH STEEL SLEEVE

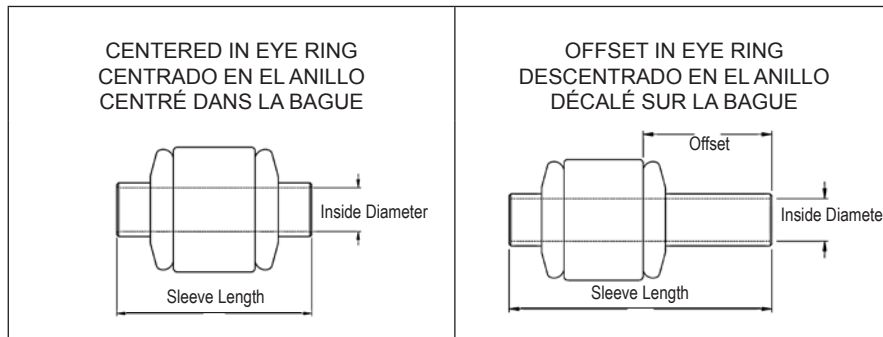

MOUNTING CODE	DIMENSION			
	Inside Diameter		Sleeve Length	
	(inches)	(mm)	(inches)	(mm)
<b>ES3</b>	0.39	10.00	1.56	39.62
<b>ES7</b>	0.56	14.29	1.25	31.75
<b>ES10</b>	0.44	11.11	1.38	35.05
<b>ES13</b>	0.56	14.29	1.89	48.01
<b>ES19</b>	0.47	12.00	1.88	47.75
<b>ES24</b>	0.50	12.70	1.38	35.05
<b>ES25</b>	0.50	12.70	1.50	38.10
<b>ES26</b>	0.50	12.70	1.56	39.62
<b>ES27</b>	0.50	12.70	1.62	41.15
<b>ES31*</b>	0.50	12.70	2.25	57.15
<b>ES34</b>	0.56	14.29	1.66	42.16
<b>ES35</b>	0.63	15.88	1.38	35.05
<b>ES36</b>	0.75	19.05	1.75	44.45
<b>ES38</b>	0.44	11.17	2.18	55.37
<b>ES41</b>	0.47	12.00	3.48	88.39
<b>ES45</b>	0.51	13.00	1.68	42.67
<b>ES48</b>	0.55	13.97	1.42	36.07

MOUNTING CODE	DIMENSION			
	Inside Diameter		Sleeve Length	
	(inches)	(mm)	(inches)	(mm)
<b>ES48</b>	0.55	13.97	1.66	42.16
<b>ES56</b>	0.55	14.00	1.58	40.13
<b>ES60</b>	0.55	14.00	1.26	32.00
<b>ES64</b>	0.63	16.00	1.25	31.75
<b>ES65</b>	0.47	12.00	1.38	35.05
<b>ES77</b>	0.79	20.07	1.48	37.59
<b>ES83</b>	0.47	12.00	1.48	37.59
<b>ES87</b>	0.48	12.30	1.65	41.91
<b>ES90</b>	0.63	15.88	2.00	50.80
<b>ES120</b>	0.75	19.05	2.76	70.10
<b>ES126</b>	0.50	12.70	2.44	61.98
<b>ES128</b>	0.50	12.70	1.66	42.16
<b>ES136</b>	0.63	15.88	1.75	44.45
<b>ES141</b>	0.47	12.00	1.61	40.89
<b>ES149</b>	0.50	12.70	2.36	59.94
<b>ES150</b>	0.75	19.05	2.24	56.90
<b>ES153</b>	0.55	14.00	1.55	39.37

\* 1" / 25.4mm Offset

\*\* 1.03" / 26.2 mm Offset

## MOUNTING CODE "ES" EYE RING AND BUSHING WITH STEEL SLEEVE (CONTINUED)

MOUNTING CODE	DIMENSION			
	Inside Diameter		Sleeve Length	
	(inches)	(mm)	(inches)	(mm)
<b>ES158</b>	0.75	19.05	3.80	96.52
<b>ES159**</b>	0.75	19.05	3.21	81.53
<b>ES160</b>	1.00	25.40	2.01	51.05
<b>ES161</b>	0.63	16.00	3.95	100.33
<b>ES162</b>	0.63	16.00	2.60	66.04
<b>ES163</b>	0.44	11.11	2.50	63.50
<b>ES164</b>	0.50	12.70	2.26	57.40
<b>ES165</b>	0.50	12.70	1.75	44.45
<b>ES171</b>	0.50	12.70	1.88	47.75
<b>ES172</b>	0.50	12.70	2.72	69.09
<b>ES174</b>	0.63	15.88	3.25	82.55
<b>ES175</b>	0.63	16.00	1.96	49.78
<b>ES176</b>	0.63	16.00	3.72	94.49

MOUNTING CODE	DIMENSION			
	Inside Diameter		Sleeve Length	
	(inches)	(mm)	(inches)	(mm)
<b>ES177</b>	0.63	16.00	3.55	90.17
<b>ES178</b>	0.75	19.05	1.96	49.78
<b>ES179</b>	0.79	20.00	1.75	44.45
<b>ES183</b>	0.79	20.00	3.80	96.52
<b>ES184</b>	0.79	20.00	1.75	44.45
<b>ES185</b>	0.47	12.00	2.44	61.98
<b>ES190</b>	0.87	22.00	1.75	44.45
<b>ES194</b>	0.88	22.23	2.28	57.91
<b>ES204</b>	0.57	14.50	1.68	42.67
<b>ES210</b>	0.73	18.50	1.87	47.50
<b>ES216</b>	0.57	14.50	3.15	80.00

### MOUNTING CODE "CL" CLEVIS

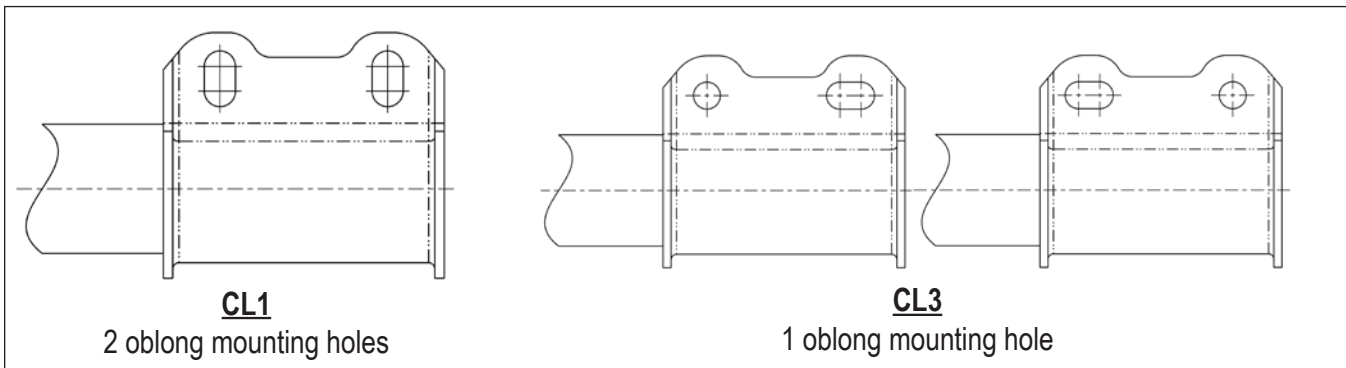

### MOUNTING CODE "LP" PINCH SOCKET

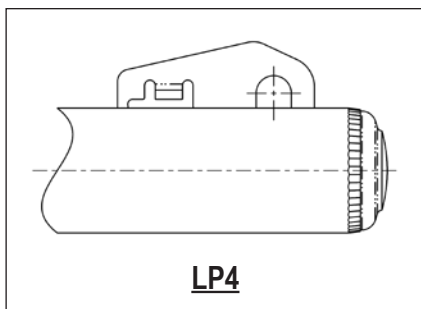

### MOUNTING CODE "LU" U JOINT

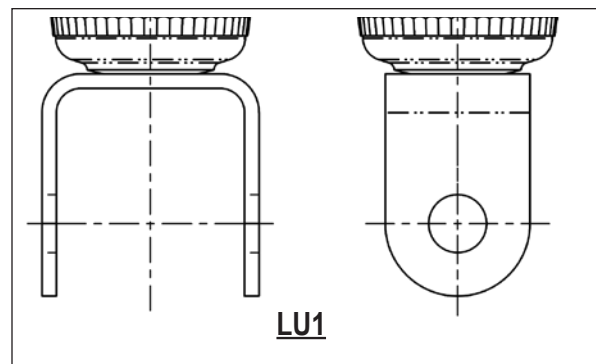

# MOUNTING CODE "TM" TOP MOUNT

## TM####

**1st & 2nd digit** - "Top Mount"

**3rd digit** - Part type/shape from the five categories listed below

**4th digit** - Number of studs / bolts (the amount of mounting points to the vehicle (see example below)

**5th digit** - Design of the mounting point - Stud (S) Bolt (B) Clip (C) (see example below)

## TOP MOUNT DESIGN SHAPES



Triangle



Square



Circle



Oval



Unique

## EXAMPLES

The fourth digit will note how many mounting points to the vehicle body exist.  
The final digits indicate the type of mounting point **Stud (S) Bolt (B) Clip(C)**  
(a combination is used for multiple mounting points)

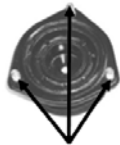

3S

3 mounting points  
stud type



2C

2 mounting points  
clip type



4S

4 mounting points  
stud type

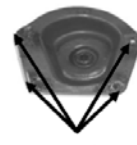

2S2B

2 mounting points, stud type  
2 mounting points, bolt type

TOP MOUNT CODE	TOP MOUNT DESIGN	MOUNTING TYPE
<b>TMR4S</b>	Rectangle	4 Stud
<b>TMT3S</b>	Triangle	3 Stud
<b>TMU2B</b>	Unique	2 bolt
<b>TMU2B1S</b>	Unique	2 Bolt, 1 Stud

**SPECIFICATIONS BY END MOUNT**  
**ESPECIFICACIONES POR TIPO DE MONTAJE**  
**SPÉCIFICATIONS PAR FIXATION DES EXTRÉMITÉS**

Gabriel	Mounting		Bore	External Diameter Illustration	Lengths			Dust Tube	Recoil Cutoff	Controls*	
	Upper	Lower			Extended	Collapsed	Stroke			Rebound	Compression
82012	BP6	ES25			16.04	10.53	5.51				
43180	BP8	ES34			23.55	14.19	9.36				
G63837	BP8	ES41	1-3/8"		28.23	17.95	10.28				
81667	BP14	ES34			26.95	16.19	10.76				
77488	BP14	ES34			26.77	16.26	10.51				
61543	BP14	ES34			26.76	16.23	10.53				
58488	BP14	ES34			26.69	16.02	10.63				
G63488	BP14	ES34			26.61	16.33	10.28				
49218	BP14	ES34			26.34	16.36	9.98				
43163	BP14	ES34			25.05	15.69	9.36				
G63638	BP14	ES34			24.33	14.8	9.53				
77638	BP14	ES34			24.31	14.78	9.53				
49231	BP14	ES34			24.27	14.79	9.48				
61565	BP14	ES34			24.26	14.73	9.53				
58638	BP14	ES34			23.87	14.49	9.38				
61687	BP14	ES34			23.87	14.68	9.19				
G63897	BP14	ES34			23.87	14.68	9.19				
77607	BP14	ES83			25.39	15.18	10.21				
77837	BP14	ES83			28.73	16.92	11.81				
G63607	BP14	ES185	1-3/8"		25.58	15.3	10.28				
G63692	EB1	EB1			27.58	16.3	11.28				
6804SE	EB1	EB1			24.08	14.67	9.41				
G63419	EB1	EB1			24.08	14.55	9.53				
14017	EB1	EB1			24.04	14.43	9.61				
6855SE	EB1	EB1			23.83	14.3	9.53				
82060	EB1	EB1			23.23	13.87	9.36				
6854SE	EB1	EB1			23.03	14.27	8.76				
81318	EB1	EB1			22.73	13.87	8.86				
6828SE	EB1	EB1			21.23	12.87	8.36				
43048	EB1	EB1			20.45	12.62	7.83				
49310	EB1	EB1			20.35	12.75	7.60				
61500	EB1	EB1			20.23	12.37	7.86				
81147	EB1	EB1			20.23	12.37	7.86				
82047	EB1	EB1			20.23	12.37	7.86				
G63907	EB1	EB1			20.23	12.37	7.86				
G63405	EB1	EB1			20.01	12.48	7.53				
77907	EB1	EB1			19.87	12.23	7.64				

\* Damping force, in pounds, to either extend or collapse the shock absorber at an average operating velocity. Fuerza de amortiguación en libras para extender o comprimir el amortiguador a una velocidad de operación promedio. La puissance d'amortissement en poids de l'amortisseur, soit comprimé, soit détendu, à une vitesse de fonctionnement moyenne.



**SPECIFICATIONS BY END MOUNT**  
**ESPECIFICACIONES POR TIPO DE MONTAJE**  
**SPÉCIFICATIONS PAR FIXATION DES EXTRÉMITÉS**

Gabriel	Mounting		Bore	External Diameter Illustration	Lengths			Dust Tube	Recoil Cutoff	Controls*	
	Upper	Lower			Extended	Collapsed	Stroke			Rebound	Compression
82007	EB1	EB1			18.23	11.37	6.86				
G63299	EB1	EB1	1-3/8"		18.08	11.55	6.53				
81676	EB1	EB1			17.73	11.12	6.61				
G63625	EB1	ES24			22.56	13.78	8.78				
6853SE	EB1	ES24			19.33	12.05	7.28				
G63394	EB1	ES24			16.01	10.48	5.53				
61525	EB1	ES24			15.01	9.95	5.06				
G63355	EB1	ES24			14.98	9.95	5.03				
81039	EB1	ES24			14.73	9.62	5.11				
34036	EB1	ES24			14.16	9.53	4.63				
82147	EB1	ES25			23.23	13.87	9.36				
81484	EB1	ES25			20.23	12.37	7.86				
G63377	EB1	ES25			20.08	12.55	7.53				
61519	EB1	ES25			19.98	12.45	7.53				
43058	EB1	ES25			19.95	12.37	7.58				
49127	EB1	ES25			19.87	12.63	7.24				
G63349	EB1	ES34			23.33	14.3	9.03				
49155	EB1	ES34			23.27	14.29	8.98				
61524	EB1	ES34			23.26	14.23	9.03				
81164	EB1	ES34			23.23	13.87	9.36				
43111	EB1	ES34			22.9	13.82	9.08				
61682	EB1	ES38			31.36	18.67	12.69				
G63888	EB1	ES38			31.36	18.67	12.69				
77952	EB1	ES38			29.68	17.43	12.25				
77986	EB1	ES48			31.01	18.65	12.36				
77987	EB1	ES48			27.24	16.38	10.86				
G64268	EB1	ES56			31.34	18.70	12.64				
G64269	EB1	ES56			26.93	16.04	10.89				
6847SE	EB1	ES65			23	13.83	9.17				
77810	EB1	ES83			31.53	18.5	13.03				
G63808	EB1	ES83			28.86	17.08	11.78				
77808	EB1	ES83			28.73	16.92	11.81				
61713	EB1	ES83			26.94	16	10.94				
G64010	EB1	ES83			26.94	16	10.94				
G63675	EB1	ES83			26.86	16.08	10.78				
81510	EB1	ES83			25.73	15.12	10.61				
G63461	EB1	ES83			25.51	15.23	10.28				

\* Damping force, in pounds, to either extend or collapse the shock absorber at an average operating velocity. Fuerza de amortiguación en libras para extender o comprimir el amortiguador a una velocidad de operación promedio. La puissance d'amortissement en poids de l'amortisseur, soit comprimé, doit détendu, à une vitesse de fonctionnement moyenne.

**SPECIFICATIONS BY END MOUNT**  
**ESPECIFICACIONES POR TIPO DE MONTAJE**  
**SPÉCIFICATIONS PAR FIXATION DES EXTRÉMITÉS**

Gabriel	Mounting		Bore	External Diameter Illustration	Lengths			Dust Tube	Recoil Cutoff	Controls*	
	Upper	Lower			Extended	Collapsed	Stroke			Rebound	Compression
61530	EB1	ES83			25.48	15.2	10.28				
77461	EB1	ES83			25.39	15.18	10.21				
81082	EB1	ES83			23.23	13.87	9.36				
61547	EB1	ES83			23.01	14.07	8.94				
43167	EB1	ES83			22.99	13.88	9.11				
G63406	EB1	ES83			22.98	13.95	9.03				
G63809	EB1	ES83			22.98	13.95	9.03				
77809	EB1	ES83			22.92	13.9	9.02				
G63673	EB1	ES83			22.3	13.77	8.53				
G63810	EB1	ES185			31.6	18.57	13.03				
58810	EB1	ES185			31.42	18.42	13.00				
G63456	EB1	ES185			26.85	16.07	10.78				
77969	EB1	ES185			25.43	15.81	9.62				
77968	EB1	ES185			24.71	15.09	9.62				
58809	EB1	ES185			23.65	14.53	9.12				
81710	EB1	ES185			21.73	13.12	8.61				
G63409	EB1	ES185			21.48	13.2	8.28				
6850SE	EB1	S1			23.3	13.77	9.53				
85063	EB2	EB2	1-5/8"	C	32.01	18.85	13.16	YES	NO	762	174
83107	EB2	EB2	1-3/8"	A	31.66	18.4	13.25	YES	NO	352	77
83314	EB2	EB2	1-3/8"	B	30.64	18.11	12.53	YES	YES	633	143
83309	EB2	EB2	1-3/8"	B	28.64	17.11	11.53	YES	YES	589	135
89409	EB2	EB2	1-5/8"	G	27.13	16.92	10.2	YES	YES	567‡	165
83312	EB2	EB2	1-3/8"	B	26.64	16.11	10.53	YES	YES	527	152
83308	EB2	EB2	1-3/8"	B	25.14	15.36	9.78	YES	YES	445	180
83519	EB2	EB2	1-3/16"	F	23.83	14.35	9.48	YES	NO	292	132
83216	EB2	EB2	1-3/8"	A	23.51	14.48	9.03	YES	YES	776	262
85054	EB2	EB2	1-5/8"	C	23.26	14.37	8.89	YES	NO	602	104
83159	EB2	EB2	1-3/8"	A	21.85	13.56	8.29	YES	NO	658	149
85012	EB2	EB2	1-5/8"	C	21.02	13.23	7.79	YES	NO	523	199
89413	EB2	EB2	1-5/8"	G	20.94	13.53	7.41	YES	NO	536‡	201
85376	EB3	EB3	1-5/8"	D	33.27	19.73	13.54	YES	NO	668	134
85301	EB3	EB3	1-5/8"	D	31.92	19.03	12.89	YES	NO	1442	455
83215	EB3	EB3	1-3/8"	A	26.64	16.36	10.28	YES	YES	697	108
89425	EB3	EB3	1-5/8"	G	26.5	16.93	9.57	YES	YES	1352‡	167
85314	EB3	EB3	1-5/8"	D	26.49	16.46	10.03	YES	YES	1216	169
89410	EB3	EB3	1-5/8"	G	26.34	16.57	9.77	YES	NO	1185‡	182

\* Damping force, in pounds, to either extend or collapse the shock absorber at an average operating velocity. Fuerza de amortiguación en libras para extender o comprimir el amortiguador a una velocidad de operación promedio. La puissance d'amortissement en poids de l'amortisseur, soit comprimé, doit détendu, à une vitesse de fonctionnement moyenne.

**SPECIFICATIONS BY END MOUNT**  
**ESPECIFICACIONES POR TIPO DE MONTAJE**  
**SPÉCIFICATIONS PAR FIXATION DES EXTRÉMITÉS**

Gabriel	Mounting		Bore	External Diameter Illustration	Lengths			Dust Tube	Recoil Cutoff	Controls*	
	Upper	Lower			Extended	Collapsed	Stroke			Rebound	Compression
85001	EB3	EB3	1-5/8"	C	26.3	16.39	9.92	YES	NO	1202	186
83140	EB3	EB3	1-3/8"	A	25.28	15.53	9.75	YES	NO	738	88
83141	EB3	EB3	1-3/8"	A	25.27	15.52	9.75	YES	NO	408	113
85329	EB3	EB3	1-5/8"	D	24.52	15.48	9.04	YES	YES	1550	232
85007	EB3	EB3	1-5/8"	C	24.33	15.4	8.93	YES	YES	1008	171
83225	EB3	EB3	1-3/8"	A	24.14	15.11	9.03	YES	YES	482	159
85307	EB3	EB3	1-5/8"	D	23.98	15.08	8.89	YES	NO	1094	173
85702	EB3	EB3	1-5/8"	D	23.76	15.85	7.91	YES	YES	1093	825
85736	EB3	EB3	1-5/8"	D	23.61	15.2	8.41	YES	YES	1155	352
89420	EB3	EB3	1-5/8"	G	22.8	14.8	8	YES	NO	862‡	258
85302	EB3	EB3	1-5/8"	D	22.75	14.61	8.14	YES	NO	836	253
85304	EB3	EB3	1-5/8"	D	22.25	14.22	8.03	YES	NO	767	325
85716	EB3	EB3	1-5/8"	D	21.99	14.33	7.66	YES	YES	1220	175
85712	EB3	EB3	1-5/8"	D	20.5	13.47	7.04	YES	YES	1435	562
83214	EB3	EB3	1-3/8"	A	19.64	12.86	6.78	YES	YES	269	90
81825	EB4	EB4			21.1	12.99	8.11				
61632	EB4	EB4			20.79	13.01	7.78				
G63183	EB4	EB4			20.79	13.01	7.78				
82065	EB4	EB4			19.04	11.93	7.11				
43085	EB4	ES27			20.61	12.78	n/a				
83119	EB4	ES165	1-3/8"	A	23.96	14.84	9.12	YES	NO	354	300
G63605	EB19	ES27			24.24	14.71	9.53				
83024	ES10	ES10	1-3/8"	2-1/2" D/T	11.65	8.66	3	YES	YES	811	320
83021	ES10	ES10	1-3/8"	A	9.41	7.4	2.01	YES	YES	745	315
82035	ES24	EB1			14.64	9.53	5.11				
49162	ES24	ES24			20.02	12.79	7.23				
G63306	ES24	ES24			19.85	12.57	7.28				
49107	ES24	ES24			19.27	12.29	6.98				
82003	ES24	ES24			18.55	11.44	7.11				
61517	ES24	ES24			14.98	9.95	5.03				
G63357	ES24	ES24			14.98	9.95	5.03				
58357	ES24	ES24			14.68	10.06	4.62				
G63403	ES26	ES26			24.58	14.8	9.78				
58403	ES26	ES26			24.48	14.95	9.53				
77403	ES26	ES26			24.31	14.78	9.53				
G63671	ES26	ES26			22.48	13.7	8.78				
81342	ES27	EB4			28.89	16.78	12.11				

\* Damping force, in pounds, to either extend or collapse the shock absorber at an average operating velocity. Fuerza de amortiguación en libras para extender o comprimir el amortiguador a una velocidad de operación promedio. La puissance d'amortissement en poids de l'amortisseur, soit comprimé, doit détendu, à une vitesse de fonctionnement moyenne.

**SPECIFICATIONS BY END MOUNT**  
**ESPECIFICACIONES POR TIPO DE MONTAJE**  
**SPÉCIFICATIONS PAR FIXATION DES EXTRÉMITÉS**

Gabriel	Mounting		Bore	External Diameter Illustration	Lengths			Dust Tube	Recoil Cutoff	Controls*	
	Upper	Lower			Extended	Collapsed	Stroke			Rebound	Compression
81091	ES27	EB4			25.14	15.28	9.86				
49149	ES27	EB4			24.93	15.64	9.29				
G63353	ES27	EB4			24.74	14.96	9.78				
49212	ES27	ES27			21.02	13.29	7.73				
G63413	ES27	ES27			20.76	12.98	7.78				
61522	ES27	ES27			20.49	12.63	7.86				
81496	ES27	ES27			20.49	12.63	7.86				
61516	ES31	ES24			18.23	11.37	6.86				
81113	ES31	ES24			18.23	11.37	6.86				
G63411	ES31	ES26			18.58	11.8	6.78				
G63347	ES31	ES35			18.08	11.55	6.53				
61710	ES34	ES34			27.58	17.14	10.44				
G63971	ES34	ES34			27.58	17.14	10.44				
77950	ES34	ES34			27.5	17.5	10.00				
77412	ES34	ES34			26.77	16.26	10.51				
61642	ES34	ES34			26.76	15.98	10.78				
81921	ES34	ES34			26.76	15.67	11.09				
58412	ES34	ES34			26.68	16.18	10.50				
G64013	ES34	ES34			26.52	16.33	10.19				
61716	ES34	ES34			26.5	16.33	10.17				
77675	ES34	ES34			26.25	15.74	10.51				
G64121	ES34	ES34			25.35	16.17	9.18				
77976	ES34	ES34			24.84	16.07	8.76				
49235	ES34	ES34			24.77	15.04	9.73				
81873	ES34	ES34			24.74	14.88	9.86				
58662	ES34	ES34			24.68	15.36	9.32				
G63662	ES34	ES34			24.58	15.05	9.53				
61600	ES34	ES34			24.51	14.98	9.53				
77662	ES34	ES34			24.31	14.78	9.53				
43181	ES34	ES34			24.24	14.88	9.36				
G63366	ES34	ES34			23.26	14.23	9.03				
G63866	ES34	ES34	1-3/8"		22.81	14.12	8.69				
G63918	ES34	ES141			21.25	13.56	7.69				
82086	ES35	ES35			25.54	14.93	10.61				
83137	ES36	ES36	1-3/8"	A	30.04	17.79	12.25	YES	YES	517	132
85976	ES36	ES36	1-5/8"	G	29.92	18.12	11.8	YES	YES	582	138
85013	ES36	ES36	1-5/8"	C	29.79	17.76	12.04	YES	YES	1019	219

\* Damping force, in pounds, to either extend or collapse the shock absorber at an average operating velocity. Fuerza de amortiguación en libras para extender o comprimir el amortiguador a una velocidad de operación promedio. La puissance d'amortissement en poids de l'amortisseur, soit comprimé, doit détendu, à une vitesse de fonctionnement moyenne.

**SPECIFICATIONS BY END MOUNT**  
**ESPECIFICACIONES POR TIPO DE MONTAJE**  
**SPÉCIFICATIONS PAR FIXATION DES EXTRÉMITÉS**

Gabriel	Mounting		Bore	External Diameter Illustration	Lengths			Dust Tube	Recoil Cutoff	Controls*	
	Upper	Lower			Extended	Collapsed	Stroke			Rebound	Compression
89414	ES36	ES36	1-5/8"	G	29.65	18.18	11.46	YES	YES	1045‡	217
83209	ES36	ES36	1-3/8"	A	29.64	17.61	12.03	YES	YES	670	78
85006	ES36	ES36	1-5/8"	C	28.54	17.13	11.41	YES	YES	1019	219
83125	ES36	ES36	1-3/8"	A	28.15	17.16	10.99	YES	YES	625	115
85043	ES36	ES36	1-5/8"	C	27.63	16.85	10.78	YES	YES	628	163
85010	ES36	ES36	1-5/8"	C	26.8	16.26	10.54	YES	YES	1019	219
83123	ES36	ES36	1-3/8"	A	26.65	16.41	10.24	YES	YES	589	119
85036	ES36	ES36	1-5/8"	C	26.38	16.29	10.09	YES	YES	633	119
89405	ES36	ES36	1-5/8"	G	26.3	16.57	9.73	YES	YES	1009‡	249
83122	ES36	ES36	1-3/8"	A	25.28	15.79	9.49	YES	YES	661	201
85005	ES36	ES36	1-5/8"	C	24.76	15.24	9.52	YES	YES	1019	219
89406	ES36	ES36	1-5/8"	G	24.76	15.82	8.93	YES	YES	658‡	125
89430	ES36	ES36	1-5/8"	G	24.61	15.66	8.94	YES	YES	1462‡	279
83126	ES36	ES36	1-3/8"	A	24.41	15.27	9.14	YES	YES	625	115
85909	ES36	ES36	1-5/8"	G	24.25	15.19	9.06	YES	YES	700	255
85030	ES36	ES36	1-5/8"	C	24.05	14.89	9.16	YES	YES	1019	219
83221	ES36	ES36	1-3/8"	A	24.01	14.73	9.28	YES	YES	599	153
89440	ES36	ES36	1-5/8"	G	23.9	15.31	8.59	YES	YES	1498‡	561
83144	ES36	ES36	1-3/8"	A	23.78	15.03	8.74	YES	YES	596	93
85058	ES36	ES36	1-5/8"	C	22.67	14.26	8.41	YES	YES	722	114
85919	ES36	ES36	1-5/8"	G	22.52	14.33	8.19	YES	YES	1265	121
89431	ES36	ES36	1-5/8"	G	22.41	14.16	8.25	YES	NO	751‡	211
85014	ES36	ES36	1-5/8"	C	21.76	13.74	8.02	YES	YES	1019	219
83124	ES36	ES36	1-3/8"	A	21.65	13.77	7.88	YES	YES	750	137
89407	ES36	ES36	1-5/8"	G	21.61	14.17	7.45	YES	YES	652‡	218
85910	ES36	ES36	1-5/8"	G	20.79	13.54	7.25	YES	YES	1074	219
85029	ES36	ES36	1-5/8"	C	20.54	13.11	7.43	YES	YES	1019	219
83127	ES36	ES36	1-3/8"	A	20.16	13.14	7.01	YES	YES	940	218
85000	ES36	ES36	1-5/8"	C	17.28	11.5	5.78	YES	YES	1019	219
89436	ES36	ES36	1-5/8"	G	17.24	12.04	5.2	YES	YES	998‡	217
83157	ES36	ES90	1-3/8"	A	26.38	15.76	10.61	YES	NO	446	303
83164	ES36	ES165	1-3/8"	C	24.22	14.59	9.63	YES	NO	426	274
85072	ES36	ES176	1-5/8"	C	24.17	14.81	9.36	YES	YES	1387	305
58808	ES41	ES41			28.38	16.75	11.63				
61614	ES41	ES41			22.98	13.95	9.03				
G64044	ES49	ES49			25.98	16.22	9.76				
G64089	ES56	ES56			20.43	13.03	7.4				

\* Damping force, in pounds, to either extend or collapse the shock absorber at an average operating velocity. Fuerza de amortiguación en libras para extender o comprimir el amortiguador a una velocidad de operación promedio. La puissance d'amortissement en poids de l'amortisseur, soit comprimé, doit détendu, à une vitesse de fonctionnement moyenne.

**SPECIFICATIONS BY END MOUNT**  
**ESPECIFICACIONES POR TIPO DE MONTAJE**  
**SPÉCIFICATIONS PAR FIXATION DES EXTRÉMITÉS**

Gabriel	Mounting		Bore	External Diameter Illustration	Lengths			Dust Tube	Recoil Cutoff	Controls*	
	Upper	Lower			Extended	Collapsed	Stroke			Rebound	Compression
14072	ES83	EB18			28.22	16.49	11.73				
81821	ES83	ES83			23.23	13.87	9.36				
G63455	ES83	ES83			22.98	13.95	9.03				
77455	ES83	ES83			22.92	13.9	9.02				
83131	ES83	ES83	1-3/8"	A	27.8	18.18	9.62	YES	NO	212	129
85995	ES90	ES36	1-5/8"	G	23.5	14.52	8.98	YES	NO	1830	173
83180	ES90	ES83	1-3/8"		30.2	21.24	8.96	YES	NO	909	204
83364	ES90	ES83	1-3/8"	A	24.06	15.07	8.99	YES	YES	855	206
85082	ES90	ES90	1-5/8"	C	28.6	20.64	7.97	YES	YES	1435	266
85926	ES90	ES90	1-5/8"	G	26.5	17.96	8.54	YES	YES	1387	279
85656	ES90	ES90	1-5/8"	G	26.49	16.94	9.55	YES	YES	1225	274
85927	ES90	ES90	1-5/8"	G	24.76	15.47	9.3	YES	YES	1288	388
83101	ES90	ES90	1-3/8"	A	24.63	15.13	9.49	YES	YES	481	142
85957	ES90	ES90	1-5/8"	G	20.78	13.19	7.6	YES	NO	1583	138
85928	ES90	ES90	1-5/8"	G	20.31	13.24	7.07	YES	NO	957	229
83135	ES90	ES90	1-3/8"	A	19.49	12.38	7.11	YES	NO	519	121
83169	ES90	ES90	1-3/8"	A	18.55	11.91	6.64	YES	NO	599	171
85122	ES120	S21	1-5/8"	C	22.22	13.78	8.44	YES	YES	926	162
83120	ES120	S21	1-3/8"	A	22.17	13.66	8.51	YES	YES	779	164
83154	ES120	S21	1-3/8"	A	20.78	12.72	8.06	YES	YES	599	140
58609	ES126	ES45			16.49	11.05	5.44				
61542	ES126	ES128			16.73	10.95	5.78				
G63609	ES126	ES128			16.5	10.97	5.53				
81726	ES126	ES128			16.48	10.87	5.61				
77609	ES126	ES128			16.43	10.95	5.48				
83160	ES128	ES36	1-3/8"	A	24.31	14.9	9.37	YES	YES	920	161
85650	ES136	ES34	1-5/8"	G	24.88	16.35	8.53	YES	NO	941	463
83056	ES136	ES136	1-5/8"	C	11.53	8.63	2.89	YES	YES	3830	737
83006	ES149	EB1	1-3/8"	A	10.71	8.52†	2.78	YES	YES	525	182
83038	ES149	EB1	1-3/8"	A	10.45†	8.41†	3	YES	YES	336	242
83039	ES149	ES149	1-3/8"	A	10.44†	8.4†	3	YES	YES	876	326
85180	ES150	ES36	1-5/8"	C	20.94	13.83	7.11	YES	YES	681	283
85181	ES150	ES150	1-5/8"	C	26.33	17.06	9.27	YES	YES	681	285
89449	ES150	ES150	1-5/8"	G	23.25	14.9	8.35	YES	NO	1519‡	324
85918	ES150	ES150	1-5/8"	G	22.97	14.58	8.39	YES	NO	1726	412
85958	ES150	ES150	1-5/8"	G	22.89	14.5	8.39	YES	YES	1926	281
89503	ES150	ES150	1-5/8"	G	21.28	13.72	7.56	YES	NO	1033‡	123
85920	ES150	ES150	1-5/8"	G	21.16	13.57	7.59	YES	NO	845	49

\* Damping force, in pounds, to either extend or collapse the shock absorber at an average operating velocity. Fuerza de amortiguación en libras para extender o comprimir el amortiguador a una velocidad de operación promedio. La puissance d'amortissement en poids de l'amortisseur, soit comprimé, doit détendu, à une vitesse de fonctionnement moyenne.

**SPECIFICATIONS BY END MOUNT**  
**ESPECIFICACIONES POR TIPO DE MONTAJE**  
**SPÉCIFICATIONS PAR FIXATION DES EXTRÉMITÉS**

Gabriel	Mounting		Bore	External Diameter Illustration	Lengths			Dust Tube	Recoil Cutoff	Controls*	
	Upper	Lower			Extended	Collapsed	Stroke			Rebound	Compression
85959	ES150	ES150	1-5/8"	G	21.16	13.57	7.59	YES	YES	1021	123
83066	ES153	ES153	1-3/8"	A	11.15†	9.2†	2.78	YES	YES	599	221
85125	ES158	ES159	1-5/8"	C	26.9	16.64	10.26	YES	YES	1479	183
85724	ES158	ES159	1-5/8"	D	22.81	14.51	8.3	YES	YES	1235	454
89443	ES158	ES159	1-5/8"	G	22.19	14.66	7.53	YES	YES	1206‡	466
85331	ES158	ES159	1-5/8"	D	19.62	12.85	6.77	YES	YES	1757	396
85335	ES158	ES159	1-5/8"	D	19.62	12.85	6.77	YES	YES	827	107
85188	ES161	ES162	1-5/8"	C	25.31	15.52	9.79	YES	YES	1074	255
83142	ES162	S42	1-3/8"	A	23.92	14.49	9.43	YES	YES	367	131
83143	ES162	S42	1-3/8"	A	21.92	13.51	8.41	YES	YES	403	137
83025	ES163	ES163	1-3/8"	A	8.02	6.53	1.48	YES	YES	710	230
83118	ES164	ES90	1-3/8"	A	24.45	14.71	9.74	YES	NO	410	311
83040	ES171	ES172	1-3/8"	A	10.44†	8.4†	3	YES	YES	876	326
89459	ES174	EB3	1-5/8"	G	25.63	16.14	9.49	YES	NO	1179‡	314
85070	ES174	EB3	1-5/8"	C	25.59	15.83	9.76	YES	NO	1100	310
85067	ES174	ES136	1-5/8"	C	30.54	18.15	12.39	YES	YES	676	170
89451	ES174	ES136	1-5/8"	G	30.39	18.54	11.86	YES	YES	645‡	172
85989	ES174	ES136	1-5/8"	G	20.78	13.15	7.63	YES	NO	1812	351
89460	ES174	ES136	1-5/8"	G	20.58	13.03	7.55	YES	NO	997‡	384
85084	ES174	ES136	1-5/8"	C	20.59	13.03	7.57	YES	NO	1145	407
85985	ES174	S43	1-5/8"	G	19.04	12.31	6.73	YES	YES	2068	723
85936	ES174	S43	1-5/8"	G	17.27	11.48	5.79	YES	YES	1479	337
89456	ES174	S43	1-5/8"	G	17.04	11.63	5.4	YES	YES	975‡	377
85986	ES175	ES150	1-5/8"	G	21.25	13.66	7.59	YES	YES	1754	221
83243	ES175	ES175	1-3/8"	A	24.41	15.26	9.15	YES	YES	296	170
83398	ES175	ES175	1-3/8"	A	23.23	15.38	7.85	YES	YES	293	168
85670	ES175	ES175	1-5/8"	G	23.19	14.67	8.52	YES	YES	591	176
83163	ES175	ES175	1-3/8"	A	20.75	13.01	7.74	YES	NO	828	98
83175	ES175	ES175	1-3/8"	A	20.48	13.19	7.29	YES	NO	1245	156
83397	ES175	ES175	1-3/8"	A	18.67	11.91	6.76	YES	NO	303	101
85031	ES176	EB2	1-5/8"	C	25.63	15.87	9.76	YES	NO	941	257
85923	ES177	ES161	1-5/8"	G	22.52	14.52	8	YES	YES	1940	221
89458	ES177	ES161	1-5/8"	G	22.48	14.6	7.88	YES	YES	1575‡	222
85932	ES178	ES150	1-5/8"	G	21.26	13.7	7.56	YES	YES	1102	430
89453	ES178	ES150	1-5/8"	G	21.14	13.93	7.21	YES	YES	860‡	435
85962	ES178	ES176	1-5/8"	G	21.8	13.66	8.15	YES	YES	2206	240
83148	ES179	ES179	1-3/8"	A	30	17.83	12.17	YES	YES	604	149

\* Damping force, in pounds, to either extend or collapse the shock absorber at an average operating velocity. Fuerza de amortiguación en libras para extender o comprimir el amortiguador a una velocidad de operación promedio. La puissance d'amortissement en poids de l'amortisseur, soit comprimé, doit détendu, à une vitesse de fonctionnement moyenne.

**SPECIFICATIONS BY END MOUNT**  
**ESPECIFICACIONES POR TIPO DE MONTAJE**  
**SPÉCIFICATIONS PAR FIXATION DES EXTRÉMITÉS**

Gabriel	Mounting		Bore	External Diameter Illustration	Lengths			Dust Tube	Recoil Cutoff	Controls*	
	Upper	Lower			Extended	Collapsed	Stroke			Rebound	Compression
85978	ES179	ES179	1-5/8"	G	29.84	18.16	11.69	YES	YES	582	138
83147	ES179	ES179	1-3/8"	A	28.54	17.4	11.15	YES	YES	358	128
83166	ES179	ES179	1-3/8"	A	25.28	15.78	9.49	YES	YES	622	132
83168	ES179	ES179	1-3/8"	A	25.28	15.78	9.49	YES	YES	246	88
85956	ES183	ES184	1-5/8"	G	30.65	18.77	11.88	YES	YES	979	373
61656	ES185	ES185			31.51	18.48	13.03				
61654	ES185	ES185			28.76	16.98	11.78				
61655	ES185	ES185			23.01	14.07	8.94				
61554	ES185	ES185			21.48	13.2	8.28				
83054	ES185	ES185	1-3/8"	A	10.28	7.56	2.72	YES	YES	1004	184
83391	ES190	ES190	1-3/8"	A	25.52	15.61	9.91	YES	NO	590	105
G64164	ES210	ES13			19.95	12.81	7.14				
G64177	ES216	ES19			25.86	16.1	9.76				
G64148	LU1	DS1			18.39	14.09	4.3				
34073	S1	BP7			14.29	9.37	4.92				
61556	S1	BP7			14.2	9.09	5.11				
G63950	S1	BP7			14.2	9.09	5.11				
G63418	S1	BP11			13.95	9.17	4.78				
81834	S1	BP13			15.7	9.84	5.86				
G63360	S1	BP13			15.7	9.92	5.78				
58359	S1	BP13			13.92	9.14	4.78				
61523	S1	BP13			13.7	8.92	4.78				
81096	S1	BP13			13.7	8.84	4.86				
G63359	S1	BP13			13.7	8.92	4.78				
34052	S1	BP13			13.62	9	4.62				
61529	S1	BP4			14.1	9.34	4.76				
6856SE	S1	EB1			27.3	15.77	11.53				
82066	S1	EB1			22.7	13.34	9.36				
43140	S1	EB1			20.92	12.84	8.08				
82155	S1	EB1			20.7	12.34	8.36				
83518	S1	EB2	1-3/16"		24.4	14.26	10.14	YES	NO	153	82
83515	S1	EB2	1-3/16"		23.34	13.89	9.45	YES	NO	643	205
G63432	S1	EB19	1-3/8"		21.11	12.83	8.28				
G63387	S1	ES25			23.32	14.04	9.28				
49178	S1	ES25			23.12	13.89	9.23				
49173	S1	ES25			19.24	12.01	7.23				
81242	S1	ES25			19.2	11.59	7.61				

\* Damping force, in pounds, to either extend or collapse the shock absorber at an average operating velocity. Fuerza de amortiguación en libras para extender o comprimir el amortiguador a una velocidad de operación promedio. La puissance d'amortissement en poids de l'amortisseur, soit comprimé, doit détendu, à une vitesse de fonctionnement moyenne.



**SPECIFICATIONS BY END MOUNT**  
**ESPECIFICACIONES POR TIPO DE MONTAJE**  
**SPÉCIFICATIONS PAR FIXATION DES EXTRÉMITÉS**

Gabriel	Mounting		Bore	External Diameter Illustration	Lengths			Dust Tube	Recoil Cutoff	Controls*	
	Upper	Lower			Extended	Collapsed	Stroke			Rebound	Compression
43099	S1	ES25			19.17	11.77	7.40				
G63350	S1	ES25			18.82	11.79	7.03				
61518	S1	ES25			18.73	11.7	7.03				
61546	S1	ES64			18.45	11.67	6.78				
6803SE	S1	S1			22.52	13.36	9.16				
82034	S1	S1			22.17	12.81	9.36				
6861SE	S1	S1			20.27	11.99	8.28				
6802SE	S1	S1			20.02	12.11	7.91				
81270	S1	S1			17.67	10.56	7.11				
61685	S11	BP9			14.12	9.68	4.44				
G63895	S11	BP9			14.12	9.68	4.44				
61683	S11	LU1			15.07	10.44	4.63				
G63893	S11	LU1			15.07	10.44	4.63				
61555	S12	BP7			14.14	9.11	5.03				
77375	S12	BP7			14.14	9.04	5.10				
G63375	S12	BP7			14.14	9.11	5.03				
81920	S12	BP11			14.71	10.1	4.61				
61641	S12	BP11			14.7	10.17	4.53				
77783	S12	BP11			14.64	10.12	4.52				
G63783	S12	BP11			14.59	10.21	4.38				
G63410	S12	EB1			18.55	11.77	6.78				
34058	S12	ES3			17.13	11.01	n/a				
81925	S12	ES7			14.7	9.59	5.11				
61521	S12	ES25			16.45	10.67	5.78				
77661	S12	ES34			13.72	9.5	4.22				
G63817	S12	ES60			15.8	11.02	4.78				
77817	S12	ES60			15.73	10.94	4.79				
61663	S12	ES60			15.7	10.92	4.78				
58817	S12	ES60			15.59	10.96	4.63				
81490	S12	ES83			14.85	9.84	5.01				
G63715	S12	ES171			28.55	16.52	12.03				
61612	S12	ES171			28.39	16.36	12.03				
81913	S12	ES171			28.39	16.28	12.11				
77715	S12	ES171			28.32	16.33	11.99				
G63778	S12	ES171			24.55	14.52	10.03				
61638	S12	ES171			24.45	14.42	10.03				
81892	S12	ES171			24.2	14.09	10.11				

\* Damping force, in pounds, to either extend or collapse the shock absorber at an average operating velocity. Fuerza de amortiguación en libras para extender o comprimir el amortiguador a una velocidad de operación promedio. La puissance d'amortissement en poids de l'amortisseur, soit comprimé, doit détendu, à une vitesse de fonctionnement moyenne.

**SPECIFICATIONS BY END MOUNT**  
**ESPECIFICACIONES POR TIPO DE MONTAJE**  
**SPÉCIFICATIONS PAR FIXATION DES EXTRÉMITÉS**

Gabriel	Mounting		Bore	External Diameter Illustration	Lengths			Dust Tube	Recoil Cutoff	Controls*	
	Upper	Lower			Extended	Collapsed	Stroke			Rebound	Compression
49237	S12	ES171			24.18	14.45	9.73				
83317	S16	ES90	1-3/8"	B	27.03	16	11.34	YES	YES		
83613	S16	S16	1-3/8"	A	21.04	12.76	8.28	YES	YES	601	242
85033	S21	EB3	1-5/8"	C	27.26	17.4	9.86	YES	YES	764	254
89427	S21	EB3	1-5/8"	G	27.19	17.62	9.57	YES	YES	794‡	253
85311	S21	EB3	1-5/8"	D	23.95	14.79	9.16	YES	YES	764	254
85988	S21	EB3	1-5/8"	G	23.84	14.87	8.97	YES	YES	1200	138
89424	S21	EB3	1-5/8"	G	23.73	15.14	8.59	YES	YES	794‡	253
83395	S21	ES178	1-3/8"	A	27.19	16.28	10.91	YES	NO	616	105
89455	S21	S21	1-5/8"	G	26.31	16.03	10.28	YES	YES	791‡	276
89447	S21	S21	1-5/8"	G	23.63	14.69	8.94	YES	YES	702‡	241
83102	S21	S21	1-3/8"	A	22.89	13.54	9.35	YES	YES	513	333
89423	S21	S21	1-5/8"	G	18.67	12.21	6.46	YES	YES	1352‡	573
G63614	S36	EB1	1-3/8"		15.09	10.06	5.03				
G51856	S92	LU1			21.18	15.11	6.07				
G57147	TMT3S	LU1			21.18	15.11	6.07				
85009	S21	ES36	1-5/8"	C	23.56	14.4	9.16	YES	YES	857	144
83134	S21	ES36	1-3/8"	A	22.27	13.51	8.77	YES	NO	430	49
85921	S21	ES36	1-5/8"	G	22.07	13.57	8.5	YES	NO	2053	339
85351	S21	ES36	1-5/8"	D	20.61	12.82	7.79	YES	NO	1887	259
83395	S21	ES178	1-3/8"	A	27.19	16.28	10.91	YES	NO	616	105
83136	S21	S21	1-3/8"	A	29.31	16.8	12.51	YES	NO	914	65
85069	S21	S21	1-5/8"	C	26.31	15.97	10.33	YES	YES	762	255
89455	S21	S21	1-5/8"	G	26.31	16.03	10.28	YES	YES	791‡	276
85071	S21	S21	1-5/8"	C	25.57	15.02	10.55	YES	NO	610	107
83456	S21	S21	1-3/8"	B	24.03	14.25	9.78	YES	YES	566	80
89447	S21	S21	1-5/8"	G	23.63	14.69	8.94	YES	YES	702‡	241
83102	S21	S21	1-3/8"	A	22.89	13.54	9.35	YES	YES	513	333
85124	S21	S21	1-5/8"	C	20.91	12.9	8.01	YES	YES	1086	222
83103	S21	S21	1-3/8"	A	19.66	11.93	7.74	YES	YES	517	301
85902	S21	S21	1-5/8"	G	19.03	12.09	6.93	YES	YES	1441	267
89423	S21	S21	1-5/8"	G	18.67	12.21	6.46	YES	YES	1352‡	573
85310	S21	S21	1-5/8"	D	18.63	11.71	6.92	YES	YES	1379	578
85900	S21	S21	1-5/8"	G	17.33	11.23	6.11	YES	YES	1467	337
81713	S29	BP7			14.42	9.31	5.11				
58489	S29	BP11			14.64	9.61	5.03				
61544	S29	BP11			14.54	9.75	4.79				

\* Damping force, in pounds, to either extend or collapse the shock absorber at an average operating velocity. Fuerza de amortiguación en libras para extender o comprimir el amortiguador a una velocidad de operación promedio. La puissance d'amortissement en poids de l'amortisseur, soit comprimé, doit détendu, à une vitesse de fonctionnement moyenne.

**SPECIFICATIONS BY END MOUNT**  
**ESPECIFICACIONES POR TIPO DE MONTAJE**  
**SPÉCIFICATIONS PAR FIXATION DES EXTRÉMITÉS**

Gabriel	Mounting		Bore	External Diameter Illustration	Lengths			Dust Tube	Recoil Cutoff	Controls*	
	Upper	Lower			Extended	Collapsed	Stroke			Rebound	Compression
G63489	S29	BP11			14.42	9.64	4.78				
77489	S29	BP11			14.36	9.55	4.81				
81668	S29	BP11			14.32	9.56	4.76				
77807	S36	EB1			15.33	10.34	4.99				
G63622	S36	EB1			15.32	10.29	5.03				
58807	S36	EB1			15.24	10.11	5.13				
G63614	S36	EB1	1-3/8"		15.09	10.06	5.03				
58622	S36	EB1			15.04	10.16	4.88				
77614	S36	EB1			15.04	10.05	4.99				
34076	S36	EB1			14.59	9.87	n/a				
81744	S36	EB1			14.52	9.76	4.76				
61591	S36	EB1			14.47	9.71	4.76				
81394	S36	ES25			17.47	11.21	6.26				
G63386	S36	ES25			16.11	10.58	5.53				
61520	S36	ES41			15.34	10.31	5.03				
G63414	S36	ES41			15.09	10.06	5.03				
81828	S36	ES83			22.72	14.21	8.51				
G63623	S36	ES83			22.57	14.29	8.28				
58623	S36	ES83			22.54	13.91	8.63				
77414	S36	ES83			15.33	10.34	4.99				
61646	S36	ES185			22.57	14.29	8.28				
77714	S38	BP7			15.34	9.84	5.50				
77949	S38	BP27			16.16	10.67	5.49				
77716	S38	ES26			15.32	9.84	5.48				
77948	S38	ES34			23.5	14.75	8.75				
G63674	S38	ES34			23.39	14.36	9.03				
G64009	S38	ES34			23.29	14.25	9.04				
61635	S38	ES34			23.27	14.24	9.03				
77674	S38	ES34			23.27	14.27	9.00				
77673	S38	ES34			22.38	13.84	8.54				
61634	S38	ES34			22.3	13.77	8.53				
81919	S38	ES34			22.3	13.54	8.76				
61680	S38	ES34			20.83	13.39	7.44				
G63886	S38	ES34			20.8	13.36	7.44				
77951	S38	ES34			20.5	13	7.50				
61599	S38	ES34			13.8	9.52	4.28				

\* Damping force, in pounds, to either extend or collapse the shock absorber at an average operating velocity. Fuerza de amortiguación en libras para extender o comprimir el amortiguador a una velocidad de operación promedio. La puissance d'amortissement en poids de l'amortisseur, soit comprimé, doit détendu, à une vitesse de fonctionnement moyenne.

**SPECIFICATIONS BY END MOUNT**  
**ESPECIFICACIONES POR TIPO DE MONTAJE**  
**SPÉCIFICATIONS PAR FIXATION DES EXTRÉMITÉS**

Gabriel	Mounting		Bore	External Diameter Illustration	Lengths			Dust Tube	Recoil Cutoff	Controls*	
	Upper	Lower			Extended	Collapsed	Stroke			Rebound	Compression
G63661	S38	ES34			13.8	9.52	4.28				
81928	S38	ES34			13.78	9.52	4.26				
77623	S38	ES83			22.38	13.84	8.54				
77980	S38	ES204			23	14.39	8.61				
83114	S40	ES35	1-3/8"	A	23.02	13.78	9.24	YES	NO	450	102
83162	S40	ES190	1-3/8"	A	24.35	14.69	9.67	YES	NO	877	52
85332	S42	ES36	1-5/8"	D	20.64	12.98	7.66	YES	YES	2351	967
85182	S43	S43	1-5/8"	C	26.86	16.04	10.82	YES	NO	708	232
G63610	S47	EB1			21.95	13.17	8.78				
G64043	S61	BP38			14.09	9.68	4.41				
61611	S62	BP7			15.48	9.95	5.53				
81912	S62	BP7			15.48	9.87	5.61				
G63714	S62	BP7			15.39	9.86	5.53				
58714	S62	BP7			15.26	9.98	5.28				
G63716	S62	ES26			16.39	9.86	6.53				
61613	S62	ES26			15.48	9.95	5.53				
81914	S62	ES26			15.48	9.87	5.61				
77967	S62	ES34			20.75	13.13	7.62				
G63969	S62	ES34			20.75	13.31	7.44				
85649	S62	ES34	1-5/8"	G	23.16	16.46	6.7	YES	NO	875	421
61714	S62	ES77			23.36	14.22	9.14				
G64011	S62	ES87			23.36	14.21	9.15				
58944	S62	ES204			20.73	13.35	7.38				
G56778	S68	CL1			21.37	14.37	7				
G51856	S92	LU1			21.18	15.11	6.07				
G57802	TMR4S	CL3			17.20	9.96	7.24				
G57816	TMT3S	LP4			27.17	18.98	8.19				
G57147	TMT3S	LU1			21.18	15.11	6.07				
G57800	TMU2B1S	LP4			26.73	19.49	7.24				
G57801	TMU2B1S	LP4			26.73	19.49	7.24				

\* Damping force, in pounds, to either extend or collapse the shock absorber at an average operating velocity. Fuerza de amortiguación en libras para extender o comprimir el amortiguador a una velocidad de operación promedio. La puissance d'amortissement en poids de l'amortisseur, soit comprimé, doit détendu, à une vitesse de fonctionnement moyenne.